

CHUM YUAN CO., LTD.



Since 1980

**The Complete Solution for Production
in Areas of Fasteners, Auto Parts,
and Forged Parts.**

Efficient

Professional

Reliable



CHUM YUAN CO., LTD.

Precision Internal Grinding Machine

(6"-3Jaw)

■ **JAG-3JAW-AAL**
(AUT)

■ **JAG-3JAW-AL**
(SEMI-AUT)

■ **JAG-3JAW-SP**
(MANUAL)



Optional Attachments:

1.45° Swivel Head

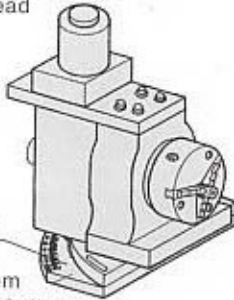

45° Swivel Head

2.Coolant System

3.Vacuum Dust Collector

4.Optical Meter

5.Enlarge-Type Internal Grinding Spindle
(12000rpm-18000rpm)

Standard Accessories :

1. ϕ 3mm Colletx1pc
2. ϕ 6mm Colletx1pc
3. Nut(M14XPO.75)X1pc
4. Tool Box and Accessories x 1 set

Applications :

- Screw Mold Inner Hole
- Wire Drawing Die Inner Hole, Taper, R, Grinding
- Tube Die Inner Hole, Taper, R, Grinding



Samples :

The Machine Have A Special Design
To Grind Blind Hole See The Figure Below

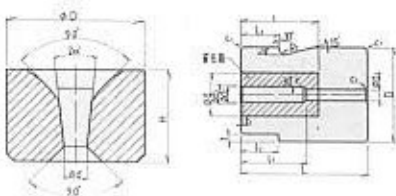

JAG-3JAW-AAL

Model	JAG-3JAW-AAL	JAG-3JAW-AL	JAG-3JAW-SP
Clamping diameters	ϕ 2.5- ϕ 150mm	ϕ 2.5- ϕ 150mm	ϕ 2.5- ϕ 150mm
Max. clamped unit length	180mm	180mm	120mm
Max.travel front to back;left to right	40mm 300mm	40mm 300mm	40mm 85mm
Cross feeding graduation	0.0025mm	0.0025mm	0.005mm
Table speed	0-4m/min	0-4m/min	-----
Roller speed	0-550rpm	0-550rpm	0-550rpm
Swivel angle	\pm 5°	\pm 5°	\pm 5°
Feeding method: front to back; left to right	AUT AUT	MANUAL AUT	MANUAL MANUAL
Spindle speed	0-55000rpm	0-55000rpm	0-55000rpm
Main Motor	Workhead	1/2HP	1/2HP
	Spindle	1HP	1HP
	Front to back	2PHX4A	-----
Left to right	2PHX2A	2PHX2A	-----
Dimensions(LxWxH)	1000x800 x1480mm	1000x800 x1480mm	900x700 x1400mm
Weight	680kgs	650kgs	530kgs
Working range(inner hole)	ϕ 1.5- ϕ 50mm	ϕ 1.5- ϕ 50mm	ϕ 1.5- ϕ 50mm

Precision Internal Grinding Machine

(8"-3Jaw)

JAG-3JAW-AAL1
(AUT)

JAG-3JAW-AL1
(SEMI-AUT)



Optional Attachments :

1. 45° Swivel Head

45° Swivel Head

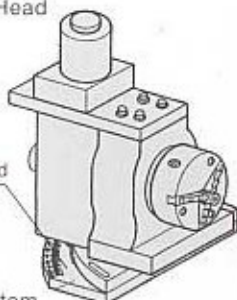

2. Coolant System

3. Vacuum Dust Collector

4. Optical Meter

5. Enlarge-Type Internal Grinding Spindle
(12000rpm-18000rpm)

Standard Accessories :

1. \varnothing 3mm Colletx1pc

2. \varnothing 6mm Colletx1pc

3. Nut(M14XPO.75)X1pc

4. Tool Box and Accessories x 1 set

Applications :

- Screw Mold Inner Hole
- Nut Mold Inner Hole
- Cold Or Hot Forge Big Tooling Inner Hole



Samples :

The Machine Have A Special Design
To Grind Blind Hole See The Figure Below

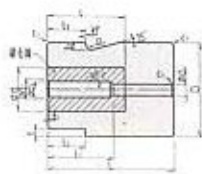

JAG-3JAW-AAL1

Model	JAG-3JAW-AAL1	JAG-3JAW-AL1
Clamping diameters	\varnothing 2.5- \varnothing 200mm	\varnothing 2.5- \varnothing 200mm
Max. clamped unit length	240mm	240mm
Max.travel front to back;left to right	200mm 520mm	200mm 520mm
Cross feeding graduation	0.0025mm	0.0025mm
Table speed	0-4m/min	0-4m/min
Roller speed	0-550rpm	0-550rpm
Swivel angle	$\pm 5^\circ$	$\pm 5^\circ$
Feeding method: front to back; left to right	AUT AUT	MANUAL AUT
Spindle speed	0-55000rpm	0-55000rpm
Main Motor	Workhead	1/2HP
	Spindle	1HP
	Front to back	5PHX1.4A
	Left to right	2PHX2A
Dimensions(LxWxH)	1700x1100 x1700mm	1700x1100 x1700mm
	Weight	1400kgs
Working range(inner hole)	\varnothing 1.5- \varnothing 80mm	\varnothing 1.5- \varnothing 80mm

Precision Internal Grinding Machine

(6"-3Jaw)

JAG-3JAW-AAL2
(AUT)

JAG-3JAW-AL2
(SEMI-AUT)



Optional Attachments :

1.45° Swivel Head

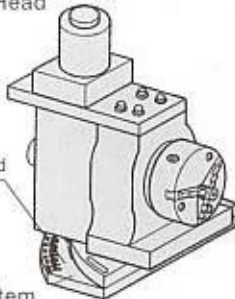

45° Swivel Head

2.Coolant System

3.Vacuum Dust Collector

4.Optical Meter

5.Enlarge-Type Internal Grinding Spindle
(12000rpm-18000rpm)

Standard Accessories :

1. ϕ 3mm Colletx1pc

2. ϕ 6mm Colletx1pc

3. Nut(M14XPO.75)X1pc

4. Tool Box and Accessories x 1 set

Applications :

■ Screw Mold

■ Special Screw Mold (Length Is Longer Than Standard)



Samples :

The Machine Have A Special Design To Grind Blind Hole See The Figure Below

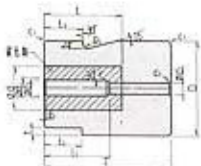

JAG-3JAW-AAL2

Model	JAG-3JAW-AAL2	JAG-3JAW-AL2
Clamping diameters	ϕ 2.5- ϕ 150mm	ϕ 2.5- ϕ 150mm
Max. clamped unit length	240mm	240mm
Max.travel front to back;left to right	200mm 520mm	200mm 520mm
Cross feeding graduation	0.0025mm	0.0025mm
Table speed	0-4m/min	0-4m/min
Roller speed	0-550rpm	0-550rpm
Swivel angle	$\pm 5^\circ$	$\pm 5^\circ$
Feeding method: front to back; left to right	AUT AUT	MANUAL AUT
Spindle speed	0-55000rpm	0-55000rpm
Main Motor	Workhead	1/2HP
	Spindle	1HP
	Front to back	5PHX1.4A
Left to right	2PHX2A	2PHX2A
Dimensions(LxWxH)	1700x1100 x1700mm	1700x1100 x1700mm
Weight	1400Kgs	1400Kgs
Working range(inner hole)	ϕ 1.5- ϕ 50mm	ϕ 1.5- ϕ 50mm

Automatic Micro Internal Grinding Machine (Chuck-Type)

JAG-3JAW-AC

Optional Attachments :

1.45° Swivel Head

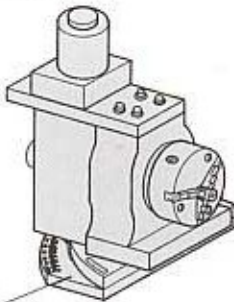

45° Swivel Head

2. Vacuum Dust Collector

3. Optical Meter

4. Enlarge-Type Internal Grinding Spindle (12000rpm-18000rpm)



JAG-3JAW-AC

Applications :

- Screw Mold Inner Hole
- Ceramic Oil Nozzle Inner Hole
- Ceramic Guide Bush
- Hole Saw



Samples :

The Machine Have A Special Design To Grind Blind Hole See The Figure Below

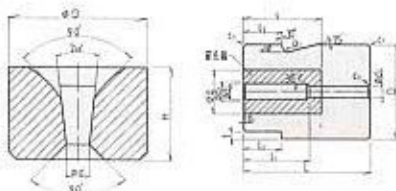

Model	JAG-3JAW-AC	Model	JAG-3JAW-AC
Clamping diameters	φ 2.5-φ 150mm	Spindle speed	0-55000rpm
Max. clamped unit length	120mm	Workhead Spindle	120W
Max.travel front to back;left to right	40mm 300mm	Main Motor	1HP
Cross feeding graduation	0.0025mm	Front to back	5PHX1.4A
Table speed	0-4m/min	Left to right	2PHX2A
Roller speed	0-550rpm	Dimensions(LxWxH)	1100x750 x1680mm
Swivel angle	±5°	Weight	900Kgs
Feeding method: front to back; left to right	automatic automatic	Working range(inner hole)	φ 1.5-φ 50mm

Standard Accessories :

1. φ 3mm Colletx1pc
2. φ 6mm Colletx1pc
3. Nut(M14XPO.75)X1pc
4. Tool Box and Accessories x 1 set

CNC Internal Grinding Machine

JAG-IG-2S-CNC (TWO SPINDLE)



Feature A

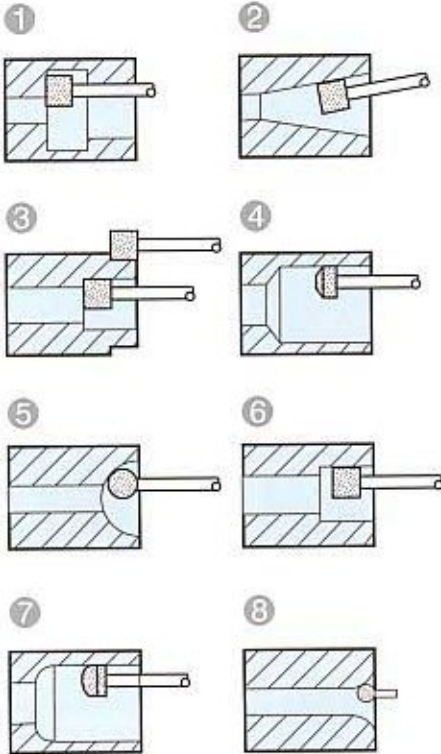

JAG-IG-2S-CNC

Feature B

This Machine Is Equipped With C-axis Which Enables The Machine To Complete Angle Grinding And Blind Hole Grinding At The Same Time. Please See The Figure Below.

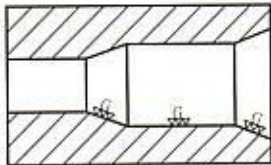

Specifications	Model	JAG-IG2S-CNC
Clamping diameters		φ 140mm
Max. clamped unit length		120mm
Max. travel	X axis	220mm
	Y axis	320mm
Min. feeding unit	X axis	0.001mm
	Y axis	0.001mm
Table speed	X axis	0-10m/min
	Y axis	0-10m/min
Workhead speed		0-600rpm
Spindle speed		0-55,000rpm
Distance between two spindles' center		150mm
Motor	Workhead	120W-AC
	Spindle	1HPX3 φ
	X axis	500w Servo
	Y axis	500w Servo
Machine dimensions(LxWxH)		1600x1360x1580mm
Weight		About 2000kgs
Working range(inner hole)		φ 1.5- φ 50mm
Standard accessories:		
1. φ 3mm Collet x 2pcs.		2. φ 6mm Collet x 2pcs.
3.Nut(M14xP0.75) x 2pcs.		4.Tool box and accessories x 1set.
Optional accessories:		
1.Magnetic coolant filter		2.Paper coolant filter
3.Vacuum dust collector		4.Internal spindle:8,000~15,000rpm
5.Caxis (500w servo)		

CNC Internal Grinding Machine

JAG-IG-CNC (ONE SPINDLE)

Feature A

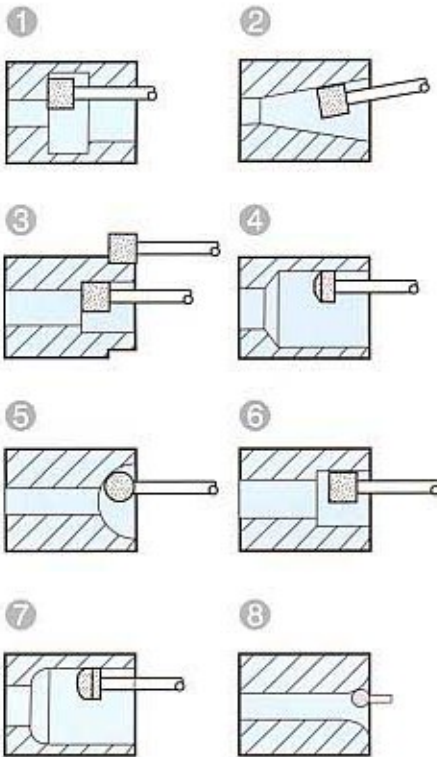

Feature B

This Machine Is Equipped With C-axis Which Enables The Machine To Complete Angle Grinding And Blind Hole Grinding At The Same Time. Please See The Figure Below.

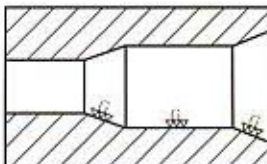

JAG-IG-CNC

Specifications	Model	JAG-IG2S-CNC
Clamping diameters		φ 140mm
Max. clamped unit length		120mm
Max. travel	X axis	220mm
	Y axis	320mm
Min. feeding unit	X axis	0.001mm
	Y axis	0.001mm
Table speed	X axis	0-10m/min
	Y axis	0-10m/min
Workhead speed		0-600rpm
Spindle speed		0-55,000rpm
Distance between two spindles' center		150mm
Motor	Workhead	120W-AC
	Spindle	1HPX3 φ
	X axis	500w Servo
	Y axis	500w Servo
Machine dimensions(LxWxH)		1600x1360x1580mm
Weight		About 2000kgs
Working range(inner hole)		φ 1.5- φ 50mm
Standard accessories:		
1. φ 3mm Collet x 2pcs.	2. φ 6mm Collet x 1 pcs.	
3.Nut(M14xP0.75) x 2pcs.	4.Tool box and accessories x 1set.	
Optional accessories:		
1.Magnetic coolant filter	2.Paper coolant filter	
3.Vacuum dust collector	4.Internal spindle:8,000-15,000rpm	
5.Caxis (500w servo)		



CENTERLESS GRINDER

- **JAG-8C**
- **JAG-12C**
- **JAG-18C**

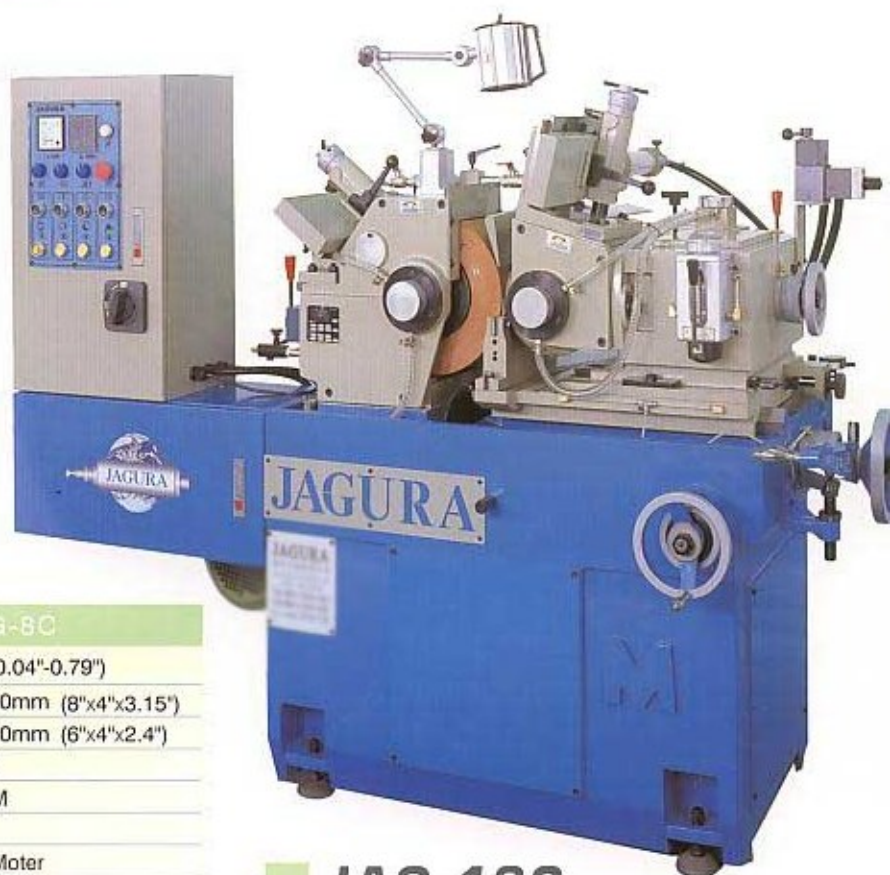

JAG-12C

Applications:

- 1.T Punch
- 2.Hex.Flange Screw OD Grinding (Aut Feeding)
- 3.Related Precision Mandrels

Samples:

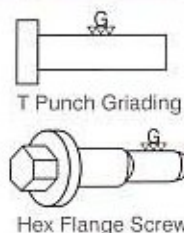

MODEL	JAG-8C
Grinding range (dia)	1-20 mm (0.04"-0.79")
Grinding wheel size (dia x width x hole)	205x100x80mm (8"x4"x3.15")
Regulating wheel size(dia x width x hole)	150x100x60mm (6"x4"x2.4")
Grinding wheel speed	2700R.P.M
Regulating wheel speed	0-400 R.P.M
Grinding wheel motor	3HP 4P
Regulating wheel motor	Hydraulic Moter
Hydraulic pump motor	1HP 4P
Coolant pump motor	1/8HP 2P
Upper slide feed graduation	2.5mm(Rev.) 0.05mm(Gra.)
Lower slide feed graduation	5mm(Rev.) 0.05mm(Gra.)
Lower slide micro feed graduation	0.2mm(Rev.) 0.001mm(Gra.)
Dressing device graduation	1.25mm(Rev.) 0.01mm(Gra.)
Regulating wheel tile angle	± 3 °
Regulating wheel swivel angle	± 5 °
Net weight(approx)	800 Kgs (1764 lbs)
Shipping gross weight (approx)	1000Kgs (2205 lbs)

MODEL	JAG-12C
Grinding range (dia)	1-30 mm (0.04"-1.58")
Grinding wheel size (dia x width x hole)	305 x 150 x 120mm (12"x6"x5")
Regulating wheel size (dia x width x hole)	205 x 150 x 90mm (8"x6"x3.54")
Grinding wheel speed	1900 R.P.M
Regulating wheel speed	0-308 R.P.M
Grinding wheel motor	7 1/2 HP 4P
Regulating wheel Hydraulic motor	Hydraulic Moter
Hydraulic pump motor	1HP 4P
Coolant pump motor	1/8HP 2P
Upper slide feed graduation	3.5mm(Rev.) 0.05mm(Gra.)
Lower slide feed graduation	7mm(Rev.) 0.05mm(Gra.)
Lower slide micro feed graduation	0.2mm(Rev.) 0.001mm(Gra.)
Dressing device graduation	1.25mm(Rev.) 0.01mm(Gra.)
Regulating wheel tile angle	± 5 °
Regulating wheel swivel angle	± 5 °
Net weight(approx)	1600Kgs(3527 lbs)
Shipping gross weight (approx)	1850Kgs(4079 lbs)
Size of case (approx) (L x W x H)	2250 x 1100 x 1700mm

MODEL	JAG-18C
Grinding range (dia)	1-50 mm (0.04"-2")
Grinding wheel size (dia x width x hole)	455 x 205 x 228.6mm (18"x8"x9")
Regulating wheel size (dia x width x hole)	255 x 205 x 111.2mm (10"x8"x4.38")
Grinding wheel speed	1350 R.P.M
Regulating wheel speed	0-308 R.P.M
Grinding wheel motor	15HP 4P
Regulating wheel motor	Hydraulic Moter
Hydraulic pump motor	1HP 4P
Coolant pump motor	1/4HP 2P
Upper slide feed graduation	4mm(Rev.) 0.05mm(Gra.)
Upper slide micro feed graduation	0.1mm(Rev.) 0.001mm(Gra.)
Lower slide feed graduation	10mm(Rev.) 0.05mm(Gra.)
Lower slide micro feed graduation	0.2mm(Rev.) 0.001mm(Gra.)
Dressing device graduation	2mm(Rev.) 0.01mm(Gra.)
Regulating wheel tile angle	± 5 °
Regulating wheel swivel angle	± 5 °
Net weight(approx)	3000Kgs (6614 lbs)
Shipping gross weight (approx)	3300Kgs (7275 lbs)

Precision Punch Grinding Machine

JAG-02

JAG-02SP

Optional Attachments :

- 1.Extension Support
(400mm long maximum)

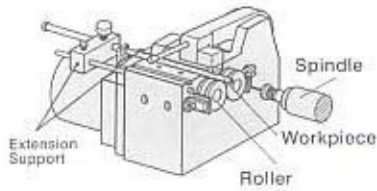

2.45° Swivel Head

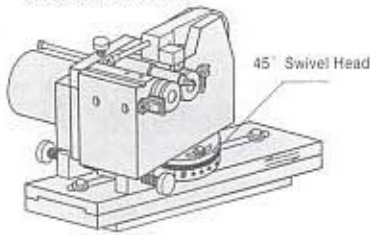

- 3.Collet Type Work Head
(ER-32)



- 4.Angle Dresser
- 5.Coolant System
- 6.Vacuum Dust Collector
- 7.Optical Meter



Standard Accessories :

- 1.Grinding Wheel ($\phi 100 \times \phi 25.4 \times 20t$) 1pc
- 2.Grinding Wheel Flangex1pc
- 3.Flange Washersx1set
- 4.Flange Extractorx1 pc
5. Tool Box and Accessories x 1 set
- 6.Radius and Plane Dresser
(As shown on picture)



Applications :

- River Punch
- Step Punch
- Related Micro Precision Mandrels



JAG-02SP

Feature :

High Concentric Easy To Operate

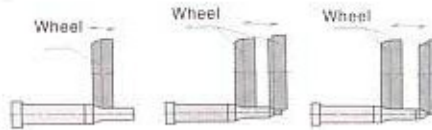

Model	JAG-02	JAG-02SP
Clamping diameters	$\phi 1 - \phi 25\text{mm}$	$\phi 1 - \phi 25\text{mm}$
Max.travel front to back left to right	40mm	40mm
	70mm	70mm
Roller speed	180rpm	0-380rpm
Swivel angle	$\pm 5^\circ$	$\pm 5^\circ$
Spindle speed	7500rpm	0-12000rpm
Main Motor	3/4HP .3 ϕ	3/4HP .3 ϕ
Dimensions(LxWxH)	900x700	900x700
	x1400mm	x1400mm
Weight	160kgs	180kgs
Working range (Outside diameter)	$\phi 0.3 - \phi 25\text{mm}$	$\phi 0.3 - \phi 25\text{mm}$

Philip Punch Pin(Relieve) Grinding Machine

JAG-PIN-OD-AAL
(AUT)

JAG-PIN-OD-SP
(MANUAL)



JAG-PIN-OD-AAL

Optional Attachments :

- 1.Coolant System
- 2.Vacuum Dust Collector
- 3.Optical Meter

Standard Accessories :

- 1.Grinding Wheel ($\phi 100 \times \phi 25.4 \times 20t$) 1pc
- 2.Grinding Wheel Flangex1pc
- 3.Flange Washersx1set
- 4.Flange Extractorx1 pc
5. Tool Box and Accessories x 1 set
- 6.Radius and Plane Dresser (As shown on picture)

Applications :

Philip Punch Pin(Relieve)
Grinding Machine

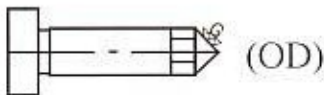

Samples :



Model	JAG-PIN-OD-AAL	JAG-PIN-OD-SP
Clamping diameters	$\phi 1.5 - \phi 40\text{mm}$	$\phi 1.5 - \phi 40\text{mm}$
Max.travel front to back;left to right	300mm 300mm	45mm 100mm
Cross feeding graduation	0.0025mm	0.005mm
Table speed	0-4m/min	
Roller speed	0-380rpm	0-380rpm
Swivel angle	$\pm 45^\circ$	$\pm 45^\circ$
Feeding method: front to back; left to right	AUT AUT	MANUAL MANUAL
Spindle speed	0-12000rpm	0-12000rpm
Roller	25W	25W
Spindle	3/4HP	3/4HP
Front to back	5PH*1.4A	
Left to right	2PH*2A	
Dimensions(LxWxH)	1000x800x1480mm	900x700x1400mm
Weight	650kg	240kg

Philip Punch Pin(Indent) Grinding Machine

**JAG-PIN-ID-AAL
(AUT)**

**JAG-PIN-ID-SP
(MANUAL)**



Optional Attachments :

1. Coolant System
2. Vacuum Dust Collector
3. Optical Meter

Standard Accessories :

1. ϕ 3mm Colletx1pc
2. ϕ 6mm Colletx1pc
3. Nut(M14XPO.75)X1pc
4. Tool Box and Accessories x 1 set

JAG-PIN-ID-AAL

Applications :

Philip Punch Pin (Indent)
Grinding Machine

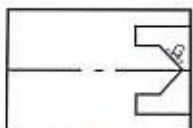

(ID)

Samples :

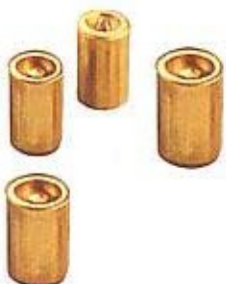

Model	JAG-PIN-ID-AAL	JAG-PIN-ID-SP
Clamping diameters	ϕ 1.5- ϕ 25mm	ϕ 1.5- ϕ 25mm
Max. clamped unit length	120mm	120mm
Max.travel front to back:left to right	40mm 150mm	40mm 85mm
Cross feeding graduation	0.0025mm	0.005mm
Table speed	0-4m/min	-----
Roller speed	0-380rpm	0-380rpm
Swivel angle	\pm 45°	\pm 45°
Feeding method: front to back; left to right	自動 自動	手動 手動
Spindle speed	0-5500rpm	0-5500rpm
Roller	25W	25W
Spindle	1HP	1HP
Main Motor Front to back	12W	---
Left to right	25W	---
Dimensions(LxWxH)	1000x800 x1480mm	900x700 x1400mm
Weight	550kgs	200kgs

Polygonal Punch Grinding Machine

JAG-06SP



Optional Attachments :

1. Optical Meter
2. Coolant System

Applications :

1. Complete The Hexagon And Air Hole At Same Time.
2. It Can Make Vertical Air Hole So As To Increase The Service Life And Durability Of The Punch.
3. Suitable For Grinding Fine Hexagon Carbide Punch.

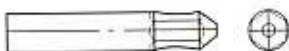

JAG-06SP

Model	JAG-06SP
Clamping diameters	φ 1- φ 20mm
Max.travel front to back	150mm
left to right	100mm
left to right	80mm
Roller speed	MANUAL
Swivel angle	0-360°
Spindle speed	0-12000rpm
Main Motor	3/4HP .3 φ
Dimensions(LxWxH)	1200x1200 x1600mm
Weight	450kg
Working range	0.8mm-20mm

Micro Cylindrical Grinding Machine

- **JAG-CG175-AAL (AUT)**
- **JAG-CG175-AL (SEMI-AUT)**
- **JAG-CG175-SP (MANUAL)**

Optional Attachments :

1. Wheel Balance Stand
2. Magnetic Coolant Separator
3. Optical Meter
4. 3" 3Jaw Chuck Workhead



5. Roller-Type Workhead



JAG-CG175-AAL

Standard Accessories :

1. Wheel Flange :1 Set
2. Wheel Balancing Arbor:1 Set
3. Wheel Flange Removing Nut:1 Piece
4. Table Mounting Dresser:1 Set
5. Tungsten Carbide TIPPED Center:2 pieces
6. Work Driving Dog Set(small, medium, large):1 set
7. Tool Box:1 set
8. Coolant System

Applications :

- Carbide Bush
- Carbide Punch
- Related Micro Precision Mandrels



Model	JAG-CG-175AAL	JAG-CG-175AL	JAG-CG-175SP	
Clamping diameters	φ 120mm	φ 120mm	φ 120mm	
Max. clamped unit length	175mm	175mm	175mm	
Cross feeding graduation	0.0025mm	0.0025mm	0.0025mm	
Roller speed	0-360rpm	0-360rpm	0-360rpm	
Swivel angle	± 6°	± 6°	± 6°	
Feeding method: front to back; left to right	Automatic	Manual	Manual	
	Automatic	Automatic	Manual	
Spindle speed	0-3440rpm	0-3440rpm	0-3440rpm	
Main Motor	Workhead	60W	60W	
	Spindle	1.5HP	1.5HP	1.5HP
	Front to back	5PHX1.4A	-----	-----
	Left to right	20W (AC)	20W (AC)	-----
Dimensions(LxWxH)		1050x900	1050x900	1050x900
		x1472mm	x1472mm	x1472mm
Weight	630kgs	610kgs	600kgs	

Precision Punch Optidress 2E Grinding Machine

JAG-OP-02-1

OPTIDRESS 2E

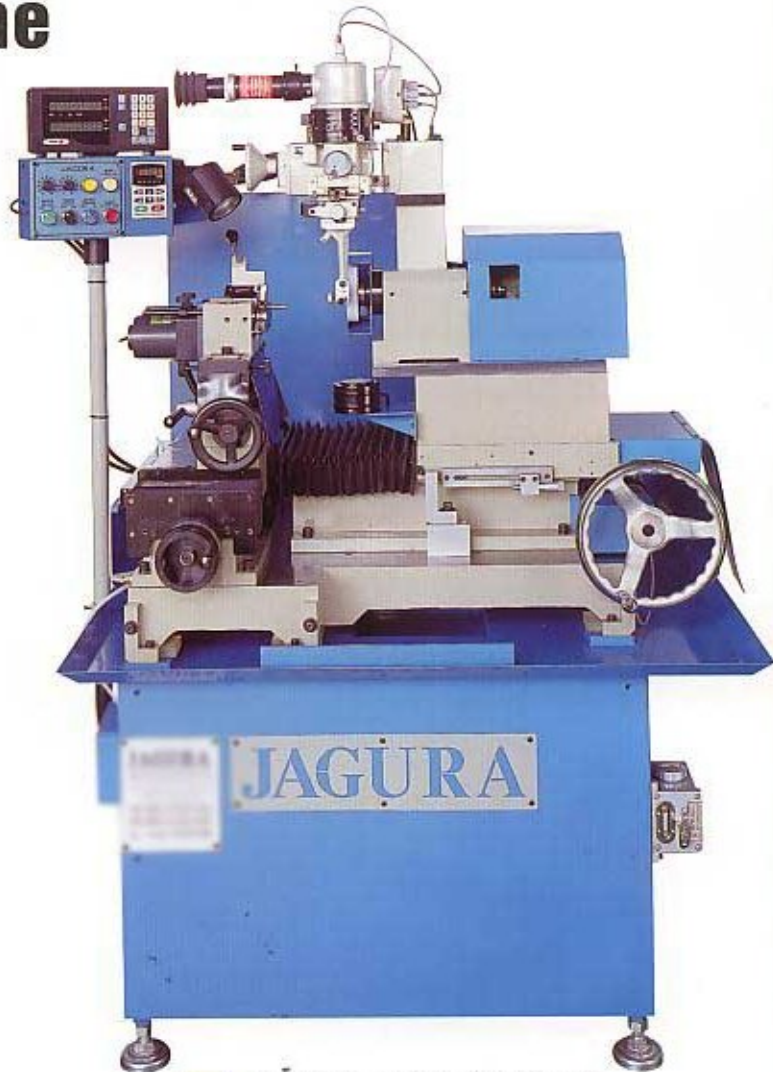
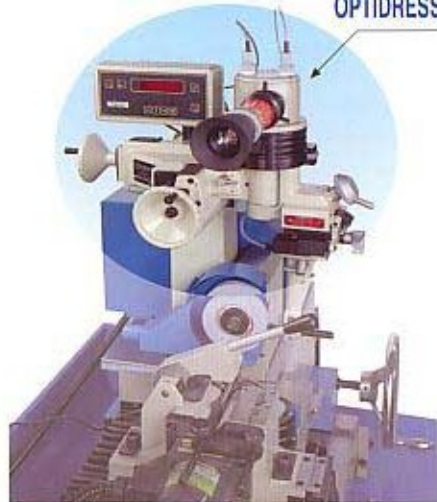

Specification

Microscope	Magnification	Field of view
		19mm
Maximum radius	Optical viewing including setting slide movement	9.5mm
	Concave by reversal of dressing arm	28.5mm
	Convex by reversal of dressing arm	38mm
Radius arm	Max rotary movement	190degrees
	Finest measurement	1 min of arc
Rad setting slide	Maximum movement	19mm
	Finest measurement	0.002mm
Tangent slide	Maximum movement	32mm
X.Y slide	Maximum movement	38mm
	Finest measurement	0.002mm
Grinding Wheel	Maximum diameter	150mm

Feature:

1. Optidress E is like a precision drafting instrument. It is easy to operate. All the dressing processes can be observed clearly through the microscope.
2. Complex shapes can be dressed on the same grinding wheel. It is not necessary to dress several shapes in different operations. That can avoid the difficult of connection.
3. The benefits of wheel dressing
 - A. The grinding wheel can be dressed many times to keep the grinding wheel at the sharpest status. That can increase the grinding efficiency and avoid the workpiece to be burnt.
 - B. In case of using softer grinding wheel, the dressing amount of one feeding can achieve up to 0.1-0.3mm. That can save the dressing time.

Applications:

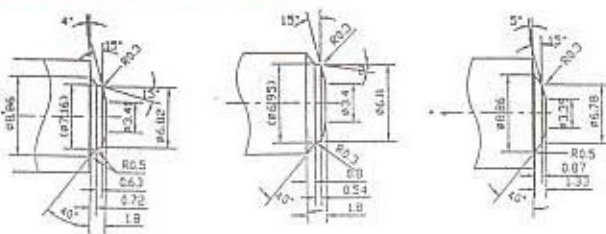

Standard Accessories:

1. Grinding Wheel (4100x425.4x20)x1pc
2. Grinding Wheel Glangex1pc
3. Flange Washers (Thick, Thin)xLset
4. Flange Extractorx1pc
5. Radius And Plane Presser
6. Angle Dresser
7. Tool Box And AccessoriesxLset

JAG-OP-02-1

Model	JAG-OP-02-1
Clamping diameters	φ 1-φ 25mm
Max.travel front to back;left to right	300mm 300mm
Cross feeding graduation	0.005mm
Table speed
Roller speed	0-380rpm
Swivel angle	± 5°
Feeding method: front to back; left to right	MANUAL MANUAL
Spindle speed	0-12000rpm
Main Motor	Workhead 25W Spindle 1HP
	Front to back Left to right

Dimensions(LxWxH)	900x700 x1400mm
Weight	550kgs
Working range(inner hole)	φ 0.3-φ 25mm

Polish Machine

■ **JAG-PG5**

■ **JAG-PG6**



■ **JAG-PG5**

Model	JAG-PG5	JAG-PG6
Clamping Diameters	φ 2.5- φ 125mm	φ 2.5- φ 150mm
Spindle Speed	0-1200rpm	0-1200rpm
Spindle Speed	1/2HP	1/2HP
Weight	100kg	100kg
Dimensions (LxWxH)	530X420X920mm	530X420X920mm