

CHUM YUAN CO., LTD.



Since 1980

**The Complete Solution for Production
in Areas of Fasteners, Auto Parts,
and Forged Parts.**

Efficient

Professional

Reliable



CHUM YUAN CO., LTD.

螺絲輸送機 (雙桿式鐵屑分離機)



功能:

- 1、本輸送機適用範圍廣，各種廠牌軋牙機均適用設計安裝。
- 2、一般小型螺絲頭部上3m/m至12m/m、長度200m/m以外規格按尺寸另設計。

特色:

- 1、排除鐵屑。
- 2、篩選不合規格尺寸螺絲。
- 3、縮小空間。
- 4、使用及保養簡便。
- 5、故障低。
- 6、本產品已受到螺絲界之認同廣用。

Function:

- 1.The application range of this conveyor is quite wide; suitable for every kinds of thread-rolling machines.
- 2.The specification of small general screws other than 3mm-12mm on the top and 200mm in length can be designed according to the required size.

CHARACTERISTIC

- 1.Removing iron chips.(characteristic)
- 2.Sifting out screws which do not meet the specification.
- 3.Reducing the required space.
- 4.Easy for operation and maintenance.
- 5.Low breakdown ratio.
- 6.This product has been widely accepted and used in the screw business field.

螺絲輸送機 (雙桿式鐵屑分離機) 規格表

SCREW CONVEYOR (Double-bar type iron chip separator) SPECIFICATIONS

型號 MODEL	外徑尺寸 OUTER DIAMETER	硬鉻電鍍 HARD CHROMIUM ELECTROPLATING	碳化處理 CARBONIZATION PROCESS
CI-50 型 3"	50 ϕ × 1050 (L) 50 ϕ × 750 (L)	0.08 mm 以上	無 NO 以實際使用需要為準 Subject to the requirement of practical application
CI-60 型 4"	60 ϕ × 1100 (L)	0.08 mm 以上	有 YES
CI-60 型 6"	60 ϕ × 1300 (L)	0.08 mm 以上	有 YES
CI-60 型 8"	60 ϕ × 1300 (L)	0.08 mm 以上	有 YES

SCREW CONVEYOR (DOUBLE-BAR TYPE IRON CHIP SEPARATOR)

零件操作保養說明 (Instructions for operation and maintenance of parts)

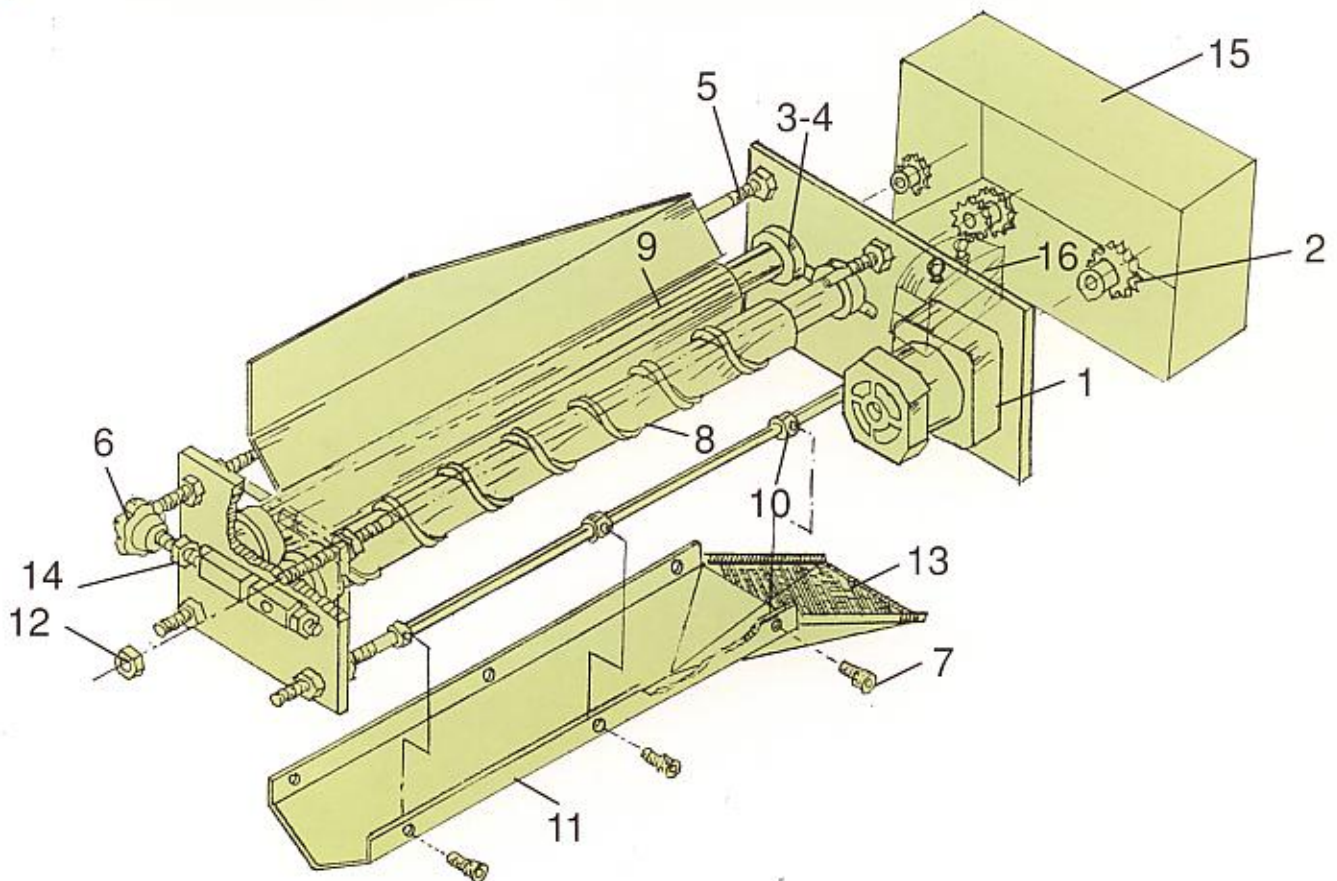

1. 馬達 Motor (60W 12.5K)
2. 齒輪 Gear (Inner diameter)
3/8 (A20T, B 13T, B 213T, C11T)
3. 軸承 Bearing (6020)
4. 軸承座 Bearing block
5. 支架 Bracket (14MM×1050×M14×50L)
6. 調整螺梅花型 Adjusting screw, plum type (M10×75M/M)

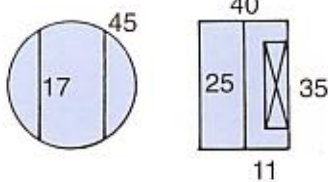

7. 螺絲 Screw (M8×P1.25×16M/M)
8. 螺絲桿 Screw rod

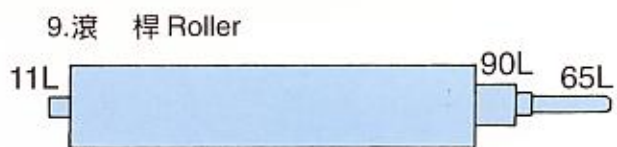
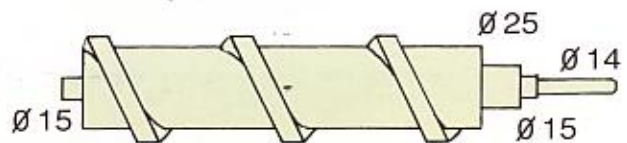

9. 滾桿 Roller
10. 承接塊六角對邊 Bolster, Hexagonal/Diagonal
11. 盛裝盤 Catch basin
12. 螺帽 Nut (M14×2.0)
13. 油網 Oil net
14. 螺帽 Nut (M10×1.5)
15. 齒輪蓋 Switch box

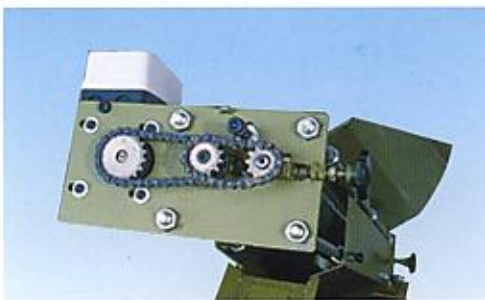

調整至適當位置再將螺帽鎖緊，請勿將螺絲桿和滾桿調整太密合
Tighten the nut after adjusting it to the proper position.
Don't adjust the screw rod and the roller too close together.

16. 電源開關，本機器與震動盤可同時斷電，安全性高。
The power switch, this machine, and the vibration panel can be turned off at the same time; it is very safe.

17. 每月傳動鍊條上黃油一次

Apply the yellow oil to the driving chain for a month usage.

螺絲輸送機

(雙桿式鐵屑分離機)

SCREW CONVEYOR
(DOUBLE-BAR TYPE IRON CHIP SEPARATOR)

專利字號新型第099686號

Patent NO. New-type No.099686

